

**SELF SUPPORTING DROP WIRE**  
**PE DROP WIRE TO TMB SPEC. OW 0004**

---

**CONDUCTOR**

Annealed Copper Wire

**INSULATION**

Black polyethylene

**SUSPENSION WIRE**

1.2mm Galvanized Steel Wire

**BREAKING LOAD**

128 kg

**ELONGATION**

3%

**CONDUCTOR DATA**

Cable Drop Wire Type	Nominal Diameter	Max. Resistance At 20°C	Min. Elongation
pr x lbs	mm	ohm/km	%
1 x 10	0.63	58.1	25
1 x 20	0.90	28.5	25

**CONSTRUCTION DATA**

Cable Type	Conductor		Steel Wire		Overall Dimension	Approx. Weight	Packing Length
	Diameter	Insulation Thickness	Diameter	Insulation Thickness		PE	
pr x lbs	mm	mm	mm	mm	mm x mm	kg/km	m/coil
1 x 10	0.63	1.0	1.2	1.0	6.92 x 5.51	32	250
1 x 20	0.90	1.0	1.2	1.0	7.55 x 6.50	40	250

CABLE MAKE-UP

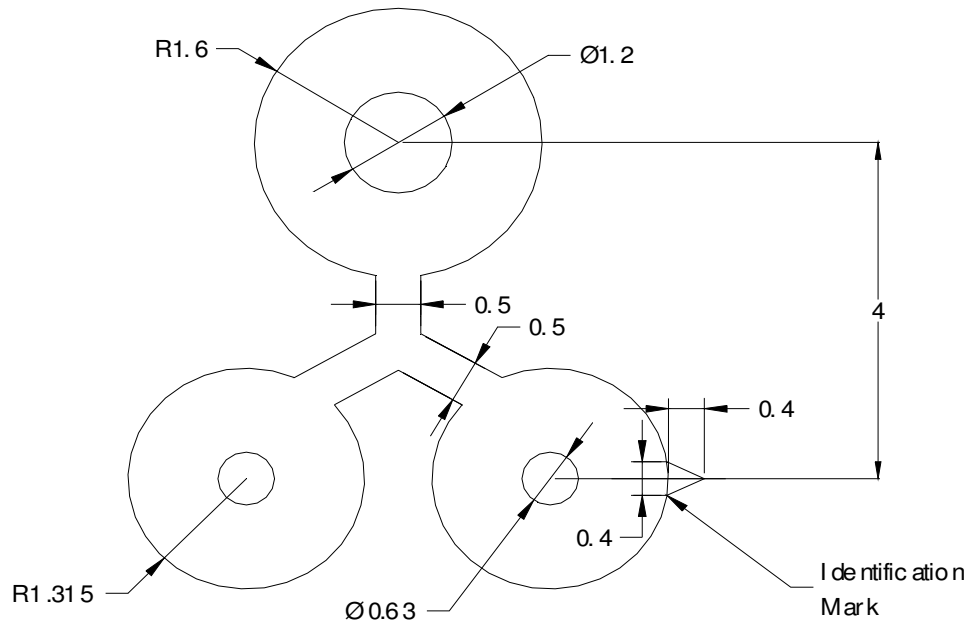

DROP WIRE NO.4

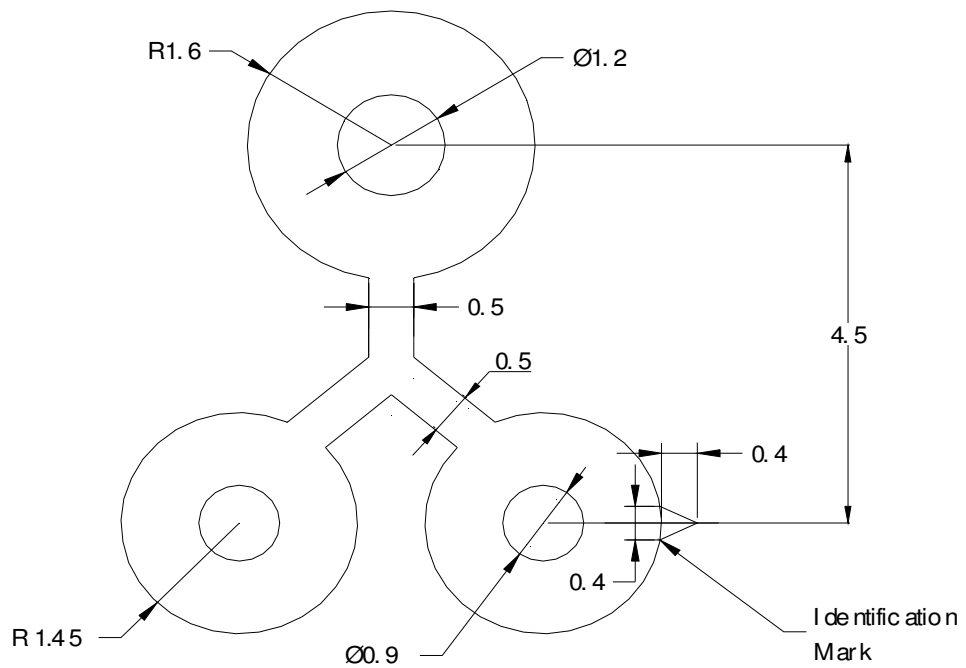

DROP WIRE NO.5